

Antelco Group of Companies

LINCOLN
Est. 1959
MOULDING THE FUTURE

ANTELCO®

Dawn

Putting Water Where it Counts!®



Antelco Australia
Antelco Pty Ltd ABN 50 008 062 708
Sales & Marketing,
Orders & Warehouse
Research & Development
PO Box 95, 131 Tolley Rd,
St Agnes SA 5097 Australia
+61 8 8334 4333
adelaide@antelco.com.au

Antelco USA
Antelco Corporation
Sales & Marketing,
Orders & Warehouse
886 Waterway Pl,
Longwood,
Florida 32750 USA
+1 407 331 0699
info@antelco.com

Antelco Europe
Antelco UK Limited
Sales & Marketing,
Orders & Warehouse
17a Chartmoor Rd,
Leighton Buzzard,
Bedfordshire LU7 4WG UK
+44 152 585 9990
orders@antelco.co.uk

Xpando™ Take-Off Fittings

antelco.com

Xpando™ Take-Off Director

Threaded Xpando™ Take-Off Directors allow direct connection of threaded sprinkler risers to HDPE and uPVC lateral pipework.

Features

- Xpando™ Take-Off Director features a collapsible barb that prevents pullout and minimises grommet damage during installation.
- 1/2" BSPM thread connection for riser.
- Large 19 mm Take-Off provides minimal friction losses.
- Capo™ Grommet with internal step combines with Xpando™ interference barb to hold off-take firmly in place.
- Use precision 19 mm Xpando™ Drill Bit to create clean round holes of the correct size to ensure reliable sealing.



Applications

Agricultural, horticultural, vineyard and landscape applications.

Ordering Information - Xpando™ Director

Type	Part Number	Pack Quantity	Packs Per Carton	Carton (lbs)
Xpando™ Director 19 mm x 1/2" BSPM	45985	25	20	22.4
Capo™ Rubber Grommet 19 mm	45755	25	50	16.1
Drill Bit for 19 mm Xpando™	51868	1	1	0.3

Ordering Information - Xpando™ Drill Bits

Type	Part Number	Pack Quantity	Packs Per Carton	Carton (lbs)
Drill Bit for Xpando™ 10 mm Fittings	51838	1	1	0.1
Drill Bit for Xpando™ 13 mm Fittings	51848	1	1	0.2
Drill Bit for Xpando™ 16 mm Fittings	51858	1	1	0.3
Drill Bit for Xpando™ 19 mm Fittings	51868	1	1	0.3

Xpando™ Director	Nom. Pipe Size (min. ID)	Min. Wall Thickness	Max. Wall Thickness	Capo™ Grommet	Hole Size Drill Bit
Xpando™ 19 mm x 1/2" BSPM	From 2"	0.06"	0.24"	19 mm	22 mm

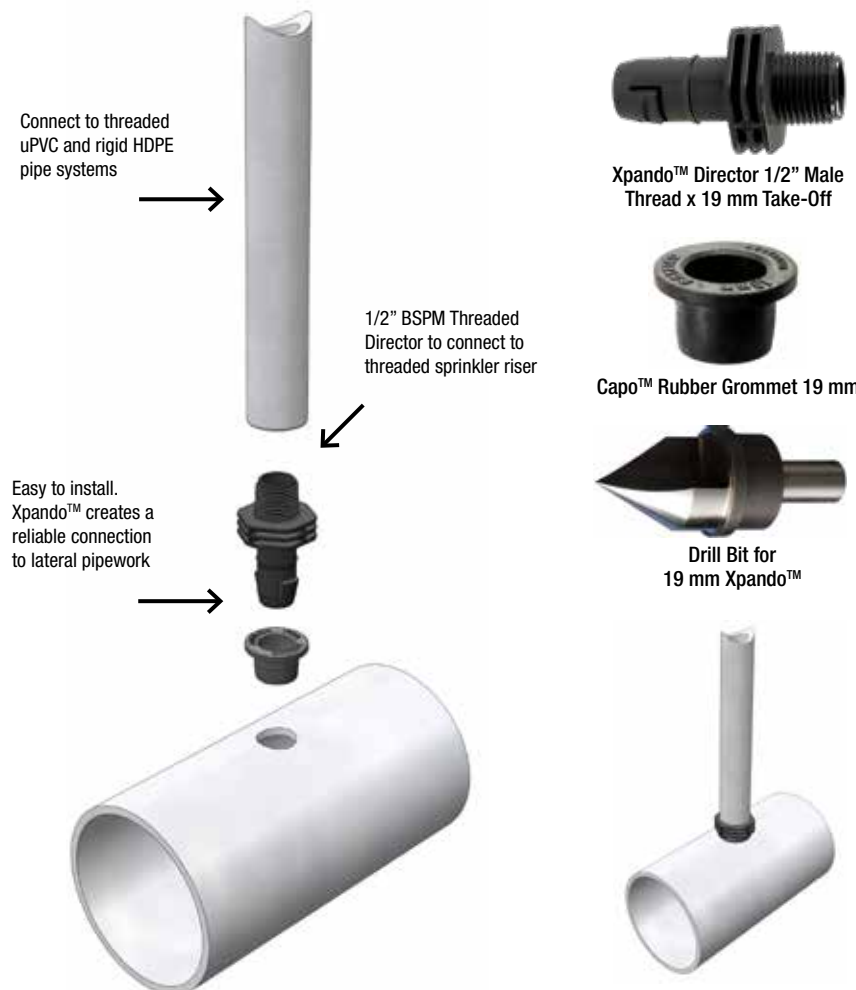

Xpando™ Take-Off Fittings

Antelco Xpando™ Take-Off Fittings are a proven method of connecting low pressure irrigation tubes and driplines to polyethylene (HDPE) tubes and PVC mainlines (class 200 or 160 only).

Features

- Easy installation saves time and costs.
- Innovative Xpando™ Take-Off Adapter with collapsible barb prevents pull-out and reduces grommet damage during installation process.
- Capo™ Grommet with internal step combines with Xpando™ interference barb to hold take-off firmly in place.
- UV stabilized materials for long life.



Applications

Agricultural, horticultural, vineyard and landscape applications.

Ordering Information - Take-Off Fittings LDPE

Type	Part Number	Pack Quantity	Packs Per Carton	Carton (lbs)
Take-Off Coupling 10 mm x 14 mm	46395	25	50	11.8
Take-Off Elbow 10 mm x 14 mm	46435	25	50	15.7

Ordering Information - Xpando™ Take-Off Adapters

Type	Part Number	Pack Quantity	Packs Per Carton	Carton (lbs)
Xpando™ 10 mm inlet x 14 mm Take-Off	45875	25	50	13.8
Xpando™ 10 mm inlet x 15 mm Take-Off	45885	25	50	14.5
Xpando™ 13 mm inlet x 13 mm Take-Off	45605	25	50	15.6
Xpando™ 13 mm inlet x 14 mm Take-Off	45595	25	40	13.5
Xpando™ 13 mm inlet x 15 mm Take-Off	45615	25	48	17.7
Xpando™ 16 mm inlet x 16 mm Take-Off	45635	25	32	17.7
Xpando™ 16 mm inlet x 18 mm Take-Off	45585	25	32	18.0
Xpando™ 19 mm inlet x 18 mm Take-Off	45995	25	25	19.4
Xpando™ 19 mm inlet x 19 mm Take-Off	45665	25	25	19.4
Xpando™ 19 mm inlet x 21 mm Take-Off	45675	25	25	18.7
Xpando™ 19 mm inlet x 25 mm Take-Off	45685	25	20	19.9

Ordering Information - Capo™ Rubber Grommets

Type	Part Number	Pack Quantity	Packs Per Carton	Carton (lbs)
Capo™ Rubber Grommet 10 mm	45725	25	50	9.5
Capo™ Rubber Grommet 13 mm	45735	25	50	7.8
Capo™ Rubber Grommet 16 mm	45745	25	50	13.3
Capo™ Rubber Grommet 19 mm	45755	25	50	16.1

Xpando™ Take-Off Adapter	Min. ID	Min. Wall Thickness	Max. Wall Thickness	Capo™ Grommet	Hole Size Drill Bit
Xpando™ 10 mm x 14 mm	1" only	0.06"	0.14"	10 mm (curved)	14 mm
Xpando™ 10 mm x 15 mm					
Xpando™ 13 mm x 13 mm	From 1 1/2"	0.06"	0.09"	13 mm	16 mm
Xpando™ 13 mm x 14 mm					
Xpando™ 13 mm x 15 mm					
Xpando™ 16 mm x 16 mm	From 2"	0.06"	0.14"	16 mm	19 mm
Xpando™ 16 mm x 18 mm					
Xpando™ 19 mm x 18 mm	From 2"	0.06"	0.24"	19 mm	22 mm
Xpando™ 19 mm x 19 mm					
Xpando™ 19 mm x 21 mm					
Xpando™ 19 mm x 25 mm					

