

| DRIPPERLINE FITTING SELECTION GUIDE: |                              |                           |
|--------------------------------------|------------------------------|---------------------------|
| MANUFACTURER                         | DIPLINE DESCRIPTION:         | FITS ANTELCO DB BARB SIZE |
| EURODRIP                             | PC-2, 16mm OD                | 14 mm ID                  |
| HUNTER                               | Landscape Drip Line, 17mm OD | 14 mm ID                  |
| NETAFIM                              | Techline TCV, 17mm OD        | 14 mm ID                  |
| RAIN BIRD                            | XF-SDI, 17mm OD              | 14/15 mm ID               |
| TORO                                 | T-PCB-18, 18mm OD            | 16 mm ID                  |

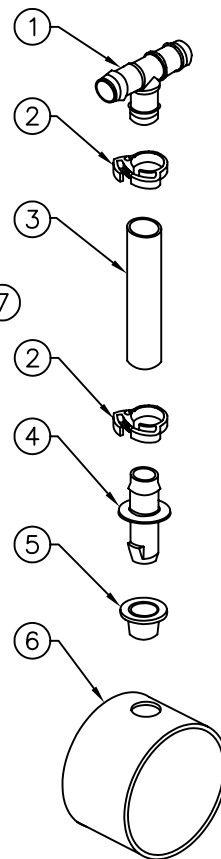

| HOLE SIZING CHART |           |
|-------------------|-----------|
| GROMMET           | HOLE SIZE |
| 13 MM             | 5/8"      |
| 16 MM             | 3/4"      |
| 19 MM             | 7/8"      |

1. ANTELCO "DB" BARBED INSERT TEE OR ELL.
2. RATCHET CLAMP AT ALL BARBED CONNECTIONS, ANTELCO.
3. BLANK DRIPLINE TUBING RISER, LENGTH AS REQUIRED.
4. XPANDO TAKE-OFF ADAPTER, ANTELCO.
5. CAPO GROMMET (ANTELCO).
6. PVC DRIPLINE MANIFOLD, SCH40 PVC PIPE, MINIMUM SIZE 1 1/2".
7. "DB BARBED ELL" (ANTELCO).
8. ASTA STAKE HOLD-DOWN, #43615" (ANTELCO). INSTALL AT TEES AND ELLS, 5' O.C. IN CLAY, 4' O.C. IN LOAM, OR 3' O.C. IN SAND.
9. INLINE DRIP EMITTER TUBING AS SPECIFIED, SEE PLAN.

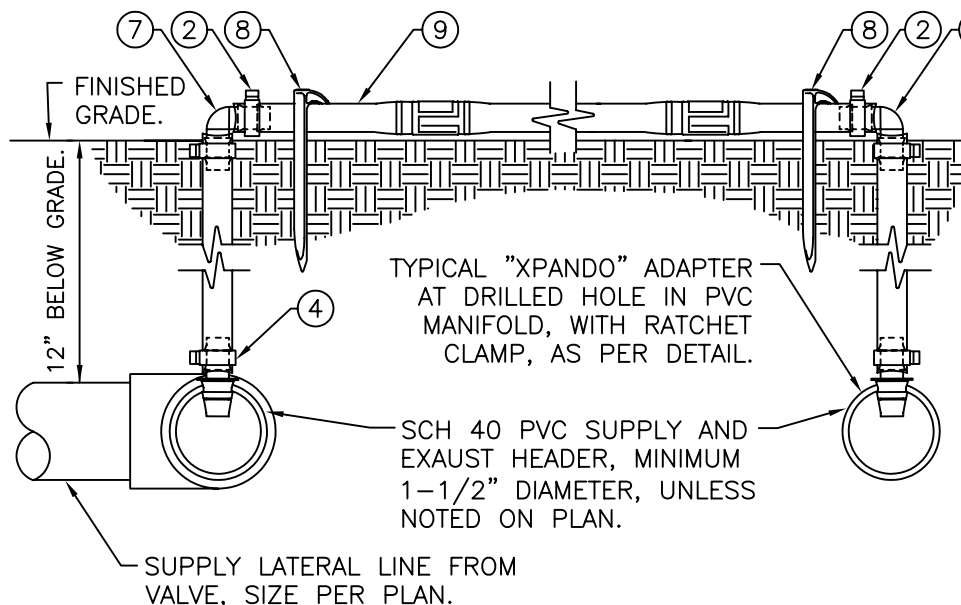
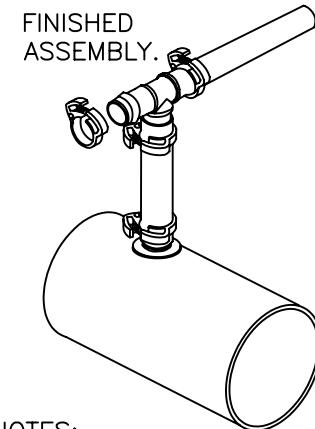

- NOTES:**
1. INSTALL RATCHET CLAMP'S ON ALL FITG'S.
  2. DRILL HOLE WITH FOSTNER DRILL BIT. THOROUGHLY FLUSH SYSTEM TO REMOVE ANY DRILL BURRS OR DEBRIS.
  3. REFER TO VARIOUS MANUFACTURER'S CATALOG'S FOR ID/OD OF INLINE DRIP TUBING – OR VISIT ANTELCO WEBSITE @ [www.anelco.com](http://www.anelco.com)